



*Genuinely interested
in serving "You"*



APSILON ENGITECH

About Us



Apsilon Engitech offer complete range of swimming pool and spa filtration components, like as Filter, Pumps, Pool Fittings and other accessories.

Apsilon Engitech also serve in the leisure market, we specialize in the design, supply, installation and maintenance of a wide variety of Swimming Pools, Spas, Olympic Pools, Hydrotherapy Pools.

We pride ourselves in the way we can adapt to your project. We specialize in providing a quality service that is tailored to exactly what you need right from the start. We provide a committed and personal service geared to meeting your expectations, regardless of the size and complexity of the project.

We install only the most up-to-date equipment available on the international market, i.e. filtration systems, automatic chemical dosing equipment, automatic pool covers, underwater lighting, counter current system, massage nozzles, etc. to ensure that you receive the very best of equipment and value for money. We deal with all aspects of the installations both for commercial and domestic installations.





Content

| | |
|--|----|
| Swimming pool Bobbin Wound Sand Filter | 02 |
| Swimming pool high flow Circulation Pumps..... | 06 |
| Swimming Pool Basin Items | 10 |
| Jacuzzi Fittings | 11 |
| Pool Side Equipment..... | 14 |
| Auto dosing (pH/ ORP) system | 15 |
| Ozone Generator..... | 16 |
| Swimming Pool Lights..... | 18 |
| Swimming Pool Maintenance Accessories..... | 19 |
| Steam Room | 21 |
| Sauna..... | 22 |
| Special Products..... | 23 |
| Heat Pumps | 24 |
| Life Saving Equipments | 26 |
| Competition Equipments | 26 |
| Readymade Jacuzzi | 27 |
| Swimming Pool Covers and Roller | 27 |
| Pipe less Filter | 28 |
| Pool Side Leisure Furniture | 30 |
| UPVC Valves- Fittings- Pipe | 32 |





Swimming pool Bobbin Wound Sand Filter



• Top Mount Valve Filter

Features

- + TOP MOUNT Sand Filters are manufactured with high grade fiberglass and resins utilizing the latest engineering techniques ensuring high quality and superior strength for long life and durability. Just as sand is utilized to clean our oceans and rivers you can enjoy the benefits of a sand filtered swimming pool.
- + High Rate Sand Filters- the natural solution for perfectly filtered pool water.
- + Heavy duty UV resistant fiberglass tank.
- + Ergonomically designed six position multiport valves.
- + High performance filtering action.
- + Resistant to chemicals and corrosion.
- + Sight glass for inspection of filtered water.
- + Pressure gauge for inspection of operating pressure.
- + Virtually maintenance free, simply backwash filters when required.
- + Sand drain plug for easier sand removal/replacement.
- + The Outlet Turbidity is Less than 2 NTU

Specifications

Maximum Working Pressure : 2.5 kg/cm² (35psi)
 Testing Pressure : 4 kg/cm²
 Maximum Water Temperature : 50° C

| Model | Design Flow m ³ /h | Filtration Area | Pipe Size | Sand Required (Kg.) | A (mm) | B (mm) |
|-----------|-------------------------------|-----------------|-----------|---------------------|--------|--------|
| T450-18" | 8.2 | 0.17 | 1.5 | 75 | 815 | 450 |
| T525-20" | 12 | 0.22 | 1.5 | 90 | 880 | 525 |
| T625-25" | 16.4 | 0.36 | 1.5 | 150 | 1005 | 625 |
| T700-28" | 21.3 | 0.41 | 1.5 | 190 | 1100 | 700 |
| T750-30" | 24.2 | 0.45 | 2.0 | 210 | 1180 | 750 |
| T800-33" | 26.8 | 0.51 | 2.0 | 300 | 1310 | 800 |
| T900-36" | 32.6 | 0.65 | 2.0 | 400 | 1380 | 900 |
| T1000-40" | 40.3 | 0.81 | 2.0 | 500 | 1495 | 1000 |
| T1100-44" | 49.0 | 0.99 | 2.0 | 600 | 1580 | 1100 |
| T1200-48" | 56.0 | 1.14 | 2.0 | 750 | 1600 | 1200 |
| T1400-56" | 76.3 | 1.56 | 2.0 | 1000 | 1810 | 1400 |

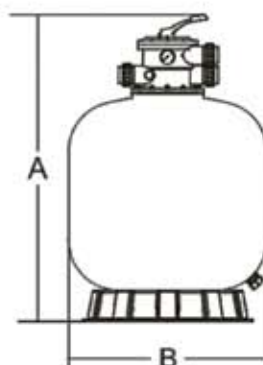

STURDY accurate Efficient
 reliable **COMPACT**

Swimming pool Bobbin Wound Sand Filter



• Side Mount Valve Filter

Features Side Mount Valve Filter

- + Side Mount Sand Filters are manufactures with high grade fiberglass and resins utilizing the latest engineering techniques ensuring high quality and superior strength for long life and durability. Just as sand is utilized to clean our oceans and rivers you can enjoy the benefits of a sand filtered swimming pool.
- + High Rate Sand Filters- the natural solution for perfectly filtered pool water.
- + Heavy duty UV resistant fiberglass tank.
- + Ergonomically designed six position multiport valves.
- + High performance filtering action.
- + Resistant to chemicals and corrosion.
- + Sight glass for inspection of filtered water.
- + Pressure gauge for inspection of operating pressure.
- + Virtually maintenance free, simply backwash filters when required.
- + Sand drain plug for easier sand removal/replacement.
- + The Outlet Turbidity is Less than 2 NTU

Specifications

Maximum Working Pressure : 2.5 kg/cm² (35psi)

Testing Pressure : 4 kg/cm²

Maximum Water Temperature : 50° Cz

| Model | Design Flow m ³ /h | Filtration Area | Pipe Size | Sand Required (Kg.) | A (mm) | B (mm) |
|-----------|-------------------------------|-----------------|-----------|---------------------|--------|--------|
| S400-16" | 6.420 | 0.13 | 1.5 | 70 | 700 | 400 |
| S450-18" | 7.920 | 0.16 | 1.5 | 80 | 730 | 450 |
| S525-22" | 12.00 | 0.22 | 1.5 | 130 | 780 | 525 |
| S650-25" | 16.34 | 0.33 | 1.5 | 170 | 880 | 650 |
| S700-28" | 20.30 | 0.41 | 1.5 | 190 | 945 | 700 |
| S750-30" | 21.78 | 0.44 | 2.0 | 210 | 960 | 750 |
| S800-33" | 24.75 | 0.50 | 2.0 | 300 | 1080 | 800 |
| S900-36" | 31.68 | 0.64 | 2.0 | 400 | 1100 | 900 |
| S1000-40" | 39.10 | 0.79 | 2.0 | 500 | 1285 | 1000 |
| S1100-44" | 47.03 | 0.95 | 2.0 | 600 | 1380 | 1100 |
| S1200-48" | 55.94 | 1.13 | 2.0 | 750 | 1500 | 1200 |
| S1400-56" | 76.23 | 1.54 | 2.0 | 1000 | 1580 | 1400 |

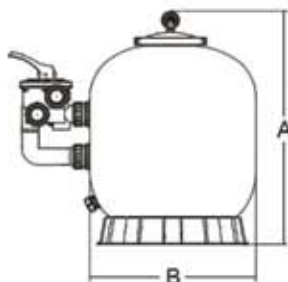

STURDY accurate Efficient
reliable **COMPACT**

Swimming pool Bobbin Wound Sand Filter



• Commercial Filter

Features

- + Commercial Sand Filters are manufactured with high grade fiberglass and resins utilizing the latest engineering techniques ensuring high quality and superior strength for long life and durability. Just as sand is utilized to clean our oceans and rivers you can enjoy the benefits of a sand filtered swimming pool.
- + It is the best choice that is applied to public pools, water amusement parks, aquariums and other water treatment facilities.
- + High Rate Sand Filters- the natural solution for perfectly filtered pool water.
- + Heavy duty UV resistant fiberglass tank.
- + Ergonomically designed six position multiport valves.
- + High performance filtering action.
- + Resistant to chemicals and corrosion.
- + A Unique and advanced design ensures fast draining and stabilizes water flow.
- + Pressure gauge for inspection of operating pressure.
- + Virtually maintenance free, simply backwash filters when required.
- + Sand drain plug for easier sand removal/replacement.
- + The Outlet Turbidity is Less than 2 NTU

Specifications

Maximum Working Pressure : 4.0 kg/cm² (58 psi)
Testing Pressure : 6 kg/cm²
Maximum Water Temperature : 50° C

| Model | Design Flow m ³ /h | Filtration Area | Pipe Size | Sand Required (Kg.) | A (mm) | B (mm) |
|---------|-------------------------------|-----------------|-----------|---------------------|--------|--------|
| SF-1200 | 56 | 1.14 | 3 | 1100 | 1450 | 1200 |
| SF-1400 | 76 | 1.56 | 4 | 1900 | 1520 | 1400 |
| SF-1600 | 100 | 2.01 | 4 | 2600 | 1760 | 1600 |
| SF-1800 | 129 | 2.54 | 4 | 3500 | 1940 | 1800 |
| SF-2000 | 157 | 3.14 | 6 | 4100 | 2420 | 2000 |
| SF-2400 | 218 | 4.34 | 6 | 8900 | 2520 | 2400 |
| SF-2500 | 246 | 4.91 | 6 | 11000 | 2680 | 2500 |

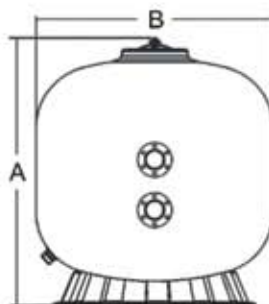

STURDY accurate Efficient
reliable **COMPACT**



Swimming pool high flow Circulation Pumps



• SQP Series Model No.:SQP75, SQP100

Applications :

SQP Series pumps are used in swimming pool, spas, Jacuzzi, bathtubs and cleaning systems.

Features :

- ★ Self Priming
- ★ Wet ends made of high reinforced engineering thermal plastic with compact structure and corrosive resistance.
- ★ 1.5 inch inlet and outlet
- ★ High efficient structure design for diffuser and impeller to get high performance.
- ★ Compact Design
- ★ Maximum Suction 1.5 mtr.

Motor :

- ★ 2 Pole induction motor single phase 220-240 V / 50 Hz Single phase with thermal protector
- ★ F Class insulation
- ★ IP55 Protection Class
- ★ Built with Thermal Protector

Overall Dimensions:

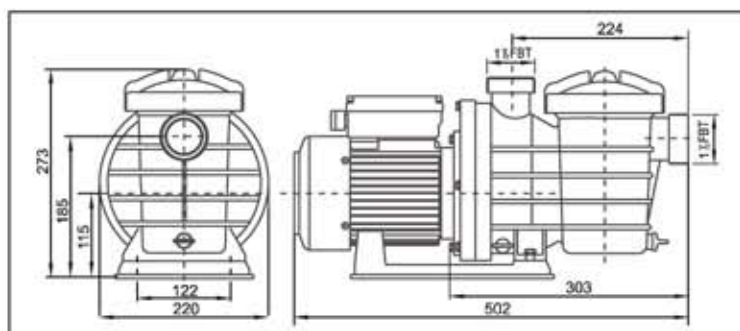

Performance Curve:

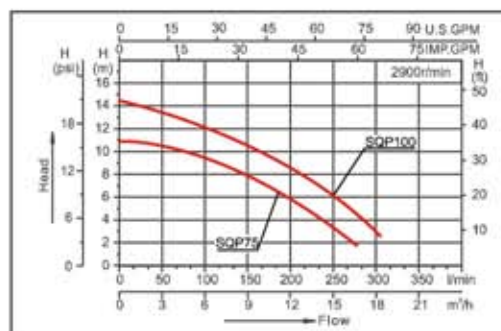

Swimming Pool Pumps :

| Model | Power KW / HP | Max Head M | Max Flow L / Min | Fitting Size mm | Dimension mm | Weight (kg) |
|--------|---------------|------------|------------------|-----------------|-----------------|-------------|
| SQP75 | 0.55/0.75 | 11 | 280 | 48.5 or 50 | 535 x 250 x 330 | 10.6 |
| SQP100 | 0.75/1.0 | 14.5 | 310 | 48.5 or 50 | 535 x 250 x 330 | 11 |



STURDY accurate Efficient
reliable **COMPACT**

Swimming pool high flow Circulation Pumps



• STP Series Model No: STP150, STP200, STP300

Applications :

STP Series pumps are used in swimming pool, spas, Jacuzzi, bathtubs and cleaning systems.

Features :

- ✦ Wet ends made of high reinforced engineering thermal plastic with compact structure and corrosive resistance.
- ✦ 2 inch inlet and outlet
- ✦ High efficient structure design for diffuser and impeller to get high performance.
- ✦ Compact Design
- ✦ Maximum Suction 1.5 mtr.

Motor :

- ✦ 2 Pole induction motor single phase 220-240 V / 50 Hz Single phase with thermal protector
- ✦ F Class insulation
- ✦ IP55 Protection Class
- ✦ Built with Thermal Protector

Overall Dimensions:

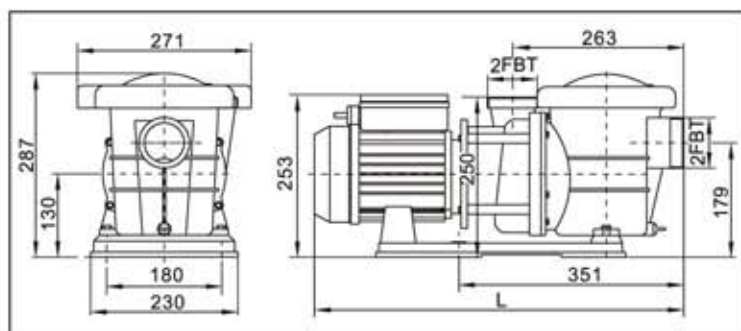

Performance Curve:

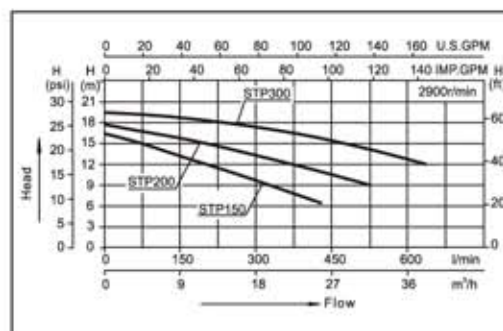

Swimming Pool Pump :

| Model | Power KW / HP | Max Head M | Max Flow L / Min | Fitting Size mm | Dimension mm | Weight (kg) |
|--------|---------------|------------|------------------|-----------------|-----------------|-------------|
| STP150 | 1.10/1.50 | 16.5 | 430 | 48.5/50/60.3/63 | 600 x 280 x 345 | 14 |
| STP200 | 1.50/2.00 | 18 | 520 | 48.5/50/60.3/63 | 600 x 280 x 345 | 15.5 |
| STP300 | 2.2/3.0 | 19 | 635 | 48.5/50/60.3/63 | 600 x 280 x 345 | 18 |



STURDY accurate Efficient
reliable **COMPACT**

Swimming pool high flow Circulation Pumps



• SWIM-2 Series

Model No: SWIM 2-150, SWIM 2-200, SWIM 2-250, SWIM 2-300, SWIM 2-400

Applications:

SWIM 2 Series pumps are used in swimming pool, spas, Jacuzzi, bathtubs and cleaning systems.

Features :

- ★ Self Priming
- ★ Wet ends made of high reinforced engineering thermal plastic with compact structure and corrosive resistance.
- ★ 2 inch inlet and outlet
- ★ High efficient structure design for diffuser and impeller to get high performance.
- ★ Maximum Suction 3.0 mtr.

Motor :

- ★ 2 Pole induction motor single phase 220-240 V / 50 Hz Single phase with thermal protector
- ★ F Class insulation
- ★ IP55 Protection Class
- ★ Built with Thermal Protector

Overall Dimensions:

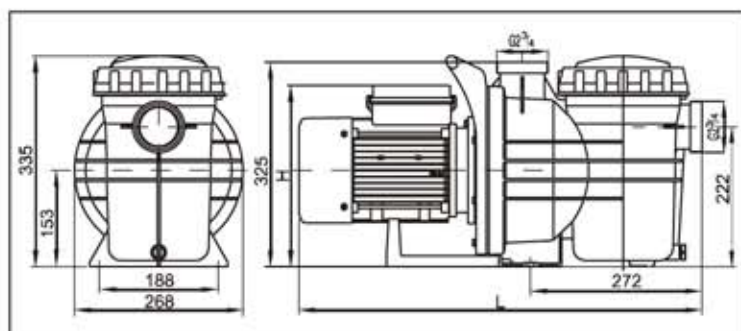

Performance Curve:

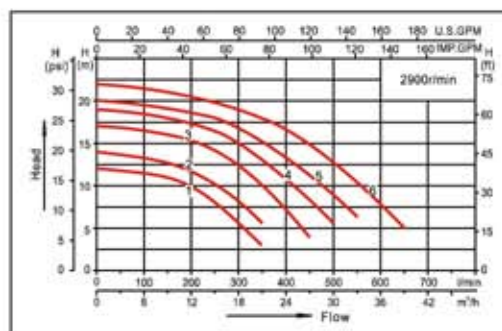

Swimming Pool Pump :

| Model | Power KW / HP | Max Head M | Max Flow L / Min | Fitting Size mm | Dimension mm | Weight (kg) |
|------------|---------------|------------|------------------|-----------------|-----------------|-------------|
| SWIM 2-150 | 1.1/1.5 | 14 | 350 | 48.5/50 | 640 x 290 x 385 | 8.9 |
| SWIM 2-200 | 1.5/2.0 | 17 | 450 | 48.5/50 | 640 x 290 x 385 | 9.5 |
| SWIM 2-250 | 1.85/2.5 | 19 | 500 | 48.5/50 | 640 x 290 x 385 | 10.5 |
| SWIM 2-300 | 2.2/3.0 | 20 | 550 | 48.5/50/60.3/63 | 640 x 290 x 385 | 14 |
| SWIM 2-400 | 3.0/4.0 | 22 | 650 | 48.5/50/60.3/63 | 665 x 290 x 385 | 15.5 |



STURDY accurate Efficient
reliable **COMPACT**



Swimming Pool Basin Items



• Main Drain

We also have with us extensive experience in successfully matching up with the demands of Square ABS Main Drain. These are highly instrumental in matching up with the specific end usage demands in swimming pools. Further, we also ensure that these qualitative ranges of Drain Traps are made available in different finish specifications. These drain taps are used in inline agitation system & can handle both liquid and solid materials to pass through it.



• Suction Inlet

Suction Inlet is the point located on the pool wall which use for the vacuuming of the bottom dust mounted in the pool.



• Floor Inlets & Eye Ball Wall Inlet

Pool inlets are the points located in the pool through which filtered water returns back into the pool after passing through the filter.



• Circular Drain

Manufactured using superior grade ABS material, round drain cover is available for both pre-fabricated and concrete pools. These drain covers can also be Customized as per the specific pool requirement.



Special Features

- ✦ Made of white ABS with UV protection Included
- ✦ Side connection with 2" thread
- ✦ Available for concrete and pre-fabricated pools.
- ✦ Drain grilles used in concrete pools with a built-in main drain

• Skimmers

• Wall Skimmers

Standard Skimmer



Wide Mouth Skimmer



• Concrete Skimmers

Standard Skimmer



Wide Mouth Skimmer



STURDY accurate Efficient
reliable **COMPACT**

• Air Water Tee Body Jet

Massage Jets for Jacuzzi in concrete & acrylic adjustable water & air flow quantity directional flow adjustment for lower & upper back & legs suitable for use with blowers.

Water Connection : 40 mm

Air Connection : 25 mm



• Air Controller

Air Volume Controller for Mixing Air in Massage Jet. Adjustable Air Volume & Muffler for Air Noise Reduction Made from ABS with 32 mm OD male Threaded Connection.

Air Controller 40 mm



• Air Bubbler Nozzle

Air Inlet Nozzles in Jacuzzi or Spa with 25 mm. Solvent & Threaded End Connection. Made from ABS. Suitable for Use with Blower.



• Spa Suction Drain

Spa Suction Drain made with ABS. Connection size 50mm dia.



• Air Blower

Side channel blower for air massage in spa pools and swimming pools. The side channel blower can be started from the poolside using pneumatic or low-voltage controls. The blower can be installed horizontally or vertically. Pipe connections are made via an air loop 50 cm above the water surface. Blower housing, blower wheel and side channel in cast aluminum.







Pool Side Equipment



- **Swimming pool Ladders**

Available in 2 steps, 3 steps, 4 steps, 5 steps



Loop Type



Overflow Type

- **Overflow Gratings**

Available size in 180 mm, 200 mm, 250 mm, 300 mm, 350 mm, 450 mm

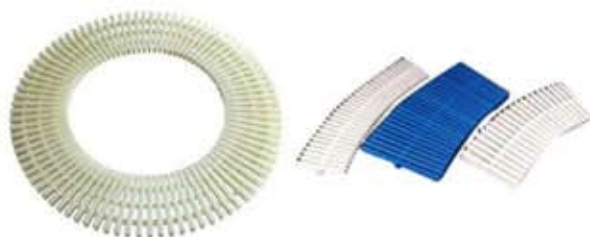

Sanitization of Pool

- **Chlorination (Chlorine Feeder and TCCA 90 %)**



TCCA 90 % Granular and Tablet Form



9 LB (4 Kg)
Online Chlorine feeder kit

- **UV System**

We are offering Sukrut UV Sterilization System to our clients. Sukrut offers a high quality Ultraviolet system for disinfection and TOC reduction.

The Sukrut range of UV Products is proven in numerous applications including:

- | | |
|-------------------------------|---------------------------|
| • Drinking Water Disinfection | • Water Reuse |
| • Drinking Water Purification | • Swimming Pool Treatment |
| • Wastewater Treatment | • Bacteria Removal |
| • Wastewater Recycling | • Virus Removal |
| • Rainwater Harvesting | • Air Disinfection |



STURDY accurate Efficient
reliable **COMPACT**

Auto dosing (pH/ ORP) system

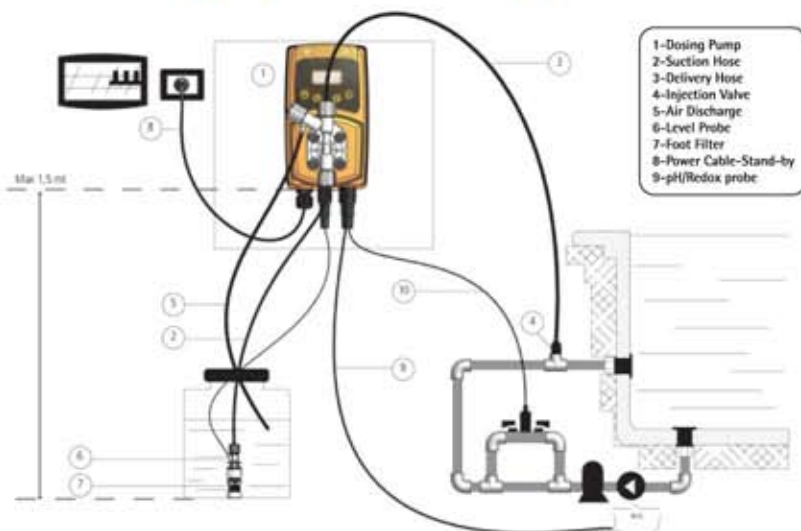

EMEC

Auto dosing pump is proportional dosing pump with level control.
It is driven by internal built-in pH or Redox (ORP) meter (electrode not included with standard scope of supply).

Ranges:

pH: 0 – 14 pH

ORP: -999mV – +999mV

FEATURES

Select pH or ORP parameter by menu: choose MODE and set pH or ORP.
In both modes, the pump can be set to dose in on / off or proportional.
In On / Off mode, the pump operates in two values (set-point)
In proportional mode the pump doses proportionally into the set point.

Fast calibration

You can perform a fast calibration on standard value.

7.0 and 4.0 for pH, 650 mV for ORP. For different value proceed to a full calibration.

Restore last calibration

If an error occur during calibration you can restore last calibration saved.

Alarms

Dosing, reading (probe failure), level and stand-by.

Alarm output status: N.O. or N.C.

DELAY

Programmable delay at dosing start up.

RESTORE FACTORY

Restore factory value (default value).

PASSWORD AND LANGUAGE

Settable password and language (EN or FR).

STAND-BY

Stand-by INPUT. (default N.O.)

VERIFY CHEMICAL COMPATIBILITY OF PUMP HEAD, O-RING AND HOSES BEFORE USE.

Refer to Chemical Compatibility table.



VMS series



WD series



AMS series



KMS series



TMS series

STURDY accurate Efficient
reliable **COMPACT**

Ozone Generator



Product Specification :

| | |
|----------------------------------|---|
| Model No. | Series – 2* / 3* / 5 / 7 / 10 / 15 / 20 / 40 |
| Make | : Chemtronics® |
| Feed Gas | : Pure Dry Oxygen |
| MOC of Ozone Cell | : SS 316 / Ceramic / PTFE / Quartz |
| Cell Cooling | : Forced Air Cooled – internally & externally |
| Power Amplifier | : MOSFET Technology |
| Driver Board Protection | : Over Heat / Over Current / Over Voltage |
| EHT | : Ferrite Based forced air cooled |
| Dielectric | : Precision Ceramic Teflon Coating |
| Enclosure – MOC | : Carbon Steel |
| Enclosure – Protection | : IP 54 |
| Enclosure – Finish | : RAL7035, structure powder coating |
| Enclosure Certification | : UL certified & CE marked |
| Indicator | : Power + Standby + Ozone ON |
| Variable Control | : 25 % – 100 % (Internal) / Fixed |
| Operating Temperature | : 20°C – 40°C |
| Operation | : Fixed / Adjustable [Output Power & Ozone Output] |
| Specified life | : 20,000 Working Hrs |
| Service Indicator | : Non Resettable Hour Meter |
| Mounting/Installation | : Floor / Wall / Skid |
| Line Voltage | : 110 V ac / 60 Hz (90 – 135 v); I phase : 230 V ac / 50 Hz (180 – 250 v); I phase |
| Oxygen Gas Sensor [Optional] | : Magnetic / Optical flow switch |
| Ozone Level Indicator [Optional] | : U.V. Photometric |



- **Applications :**
Air / Water / Waste Water
- **Standard Accessories :**
Standard
 - Oxygen Tubing : MOC – Polyurethane – 03 meter
 - Ozone Tubing : MOC – Polyurethane – 03 meter
- **Optional :**
 - Ventury : ¼", 1", 1½" (MOC – PVDF)
 - Static Mixer : 1", 1½" (PVC / SS-316)
 - Back Flow Preventer : ½" (PVC / SS-304)

Technical Specification :

| Model | Ozone Output (gm/hr) | Oxy. Flow (LPM) | Concentration (mg/l) | Dimension mm (H X W X D) | Net Wt (kg) | Power (w) |
|-------|----------------------|-----------------|----------------------|--------------------------|-------------|-----------|
| 2* | 1.2 – 2.5 | 0.5 – 2.0 | 50.0 – 35.0 | 300 x 250 x 155 | 7 | 25 |
| 3* | 2.5 – 3.5 | 0.5 – 2.0 | 82.0 – 49.0 | 400 x 300 x 210 | 10 | 90 |
| 5 | 3.0 – 5.2 | 0.5 – 2.5 | 75.0 – 50.0 | 500 x 400 x 210 | 12 | 120 |
| 7 | 4.5 – 7.5 | 1.0 – 3.0 | 70.0 – 45.0 | 500 x 400 x 210 | 13 | 150 |
| 10 | 6.5 – 11.0 | 1.0 – 5.0 | 105.0 – 45.0 | 700 x 500 x 210 | 15 | 200 |
| 15 | 12.0 – 15.0 | 3.0 – 5.0 | 90.0 – 40.0 | 700 x 500 x 210 | 16 | 220 |
| 20 | 18.0 – 22.0 | 6.0 – 10.0 | 106.0 – 50.0 | 800 x 600 x 210 | 20 | 350 |
| 40 | 30.0 – 43.0 | 6.0 – 10.0 | 100.0 – 75.0 | 700 x 500 x 210 | 32 | 500 |

STURDY accurate Efficient
reliable **COMPACT**



Swimming Pool Lights



- Halogen type

Available in 100 Watt, 12V
Color : Warm White



- LED type

Available Range:
6 Watt, 9 Watt, 12 Watt, 18 Watt, 36 Watt

Color :
Warm White, Blue, White, Green, Red



- SS LED Type

Available Range:
10 Watt, 20 Watt

Color :
RGB



STURDY accurate Efficient
reliable **COMPACT**



- Trolley Mounted Filtration System



- Trolley Mounted Suction Sweeper



- SS Vacuum Head
(with Single or Double Brush)

Range: 350mm, 450mm, 600mm, 900mm

Swimming Pool Maintenance Accessories



- Vacuum Head

Range: 14 inch and 18 inch Aluminum Vacuum Head



- Algae Brush

Range: 10 inch and 18 inch stainless steel



- Wall Brush

Range: 18 inch Nylon type wall brush



- Vacuum Hose Pipe

Range: 9 meter, 15 meter and 30 meter



- Telescope Handle

Range: 2.4 - 4.8 meter, 4.5 - 9.0 meter



- Chlorine & pH Measurement Test Kit



- Deep Rake Net



- Leaf Skimmer Net (Shallow)



STURDY accurate Efficient
reliable **COMPACT**

Steam Room Invigorating Steam Therapy



Available Range 2-20 Seaters



Steam room is made of high quality special fiber and mixed chemical proof against cracks. It can stand high temperature of 80C over 120 hours and keep original appearance without distortion and cracking.

The domed ceiling prevents condensation dropping on bathers.

Comfortable, individual seats integrated into the wall sections.



Condensation drains automatically from the seal.

Tempered safety glass door, right or left-handed opening available.

Aluminum door frame and firm aluminum handles.

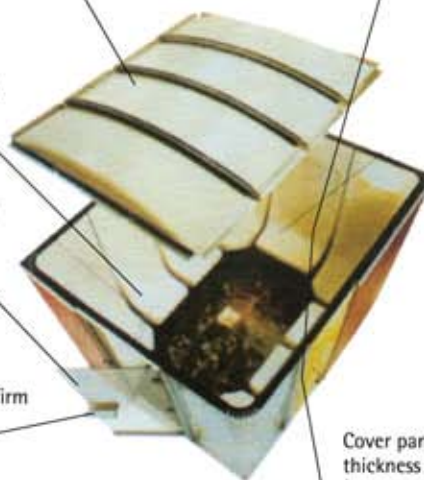

Cover panel : mahogany plywood thickness : 9mm (please order separately)
Finished with ceramic tiles, wood panel, vinyl wall covering, wallpaper or paint



STURDY accurate Efficient
reliable **COMPACT**

Sauna Refreshing and Revitalising



Infrared Sauna



Sauna Wooden Clock

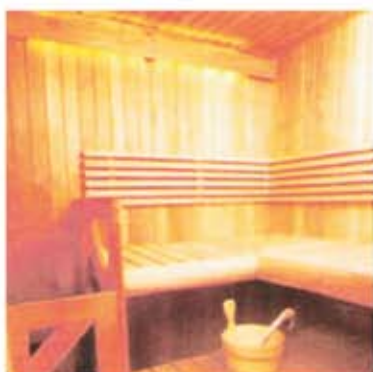

Sauna Bucket



Sauna Stone



Sauna Heater



Bath Bucket

STURDY accurate Efficient
reliable **COMPACT**

Special Products



• Robotic Pool Cleaner

- Cleans all surface types
- Climbs walls and obstacles
- Scrubs waterline
- PVA brushes for superior grip
- No installation required
- Minimal maintenance
- 'Clean filter bag' indicator (115V model only)
- Convenient caddy option available



• Counter Current System



• Endless Pool

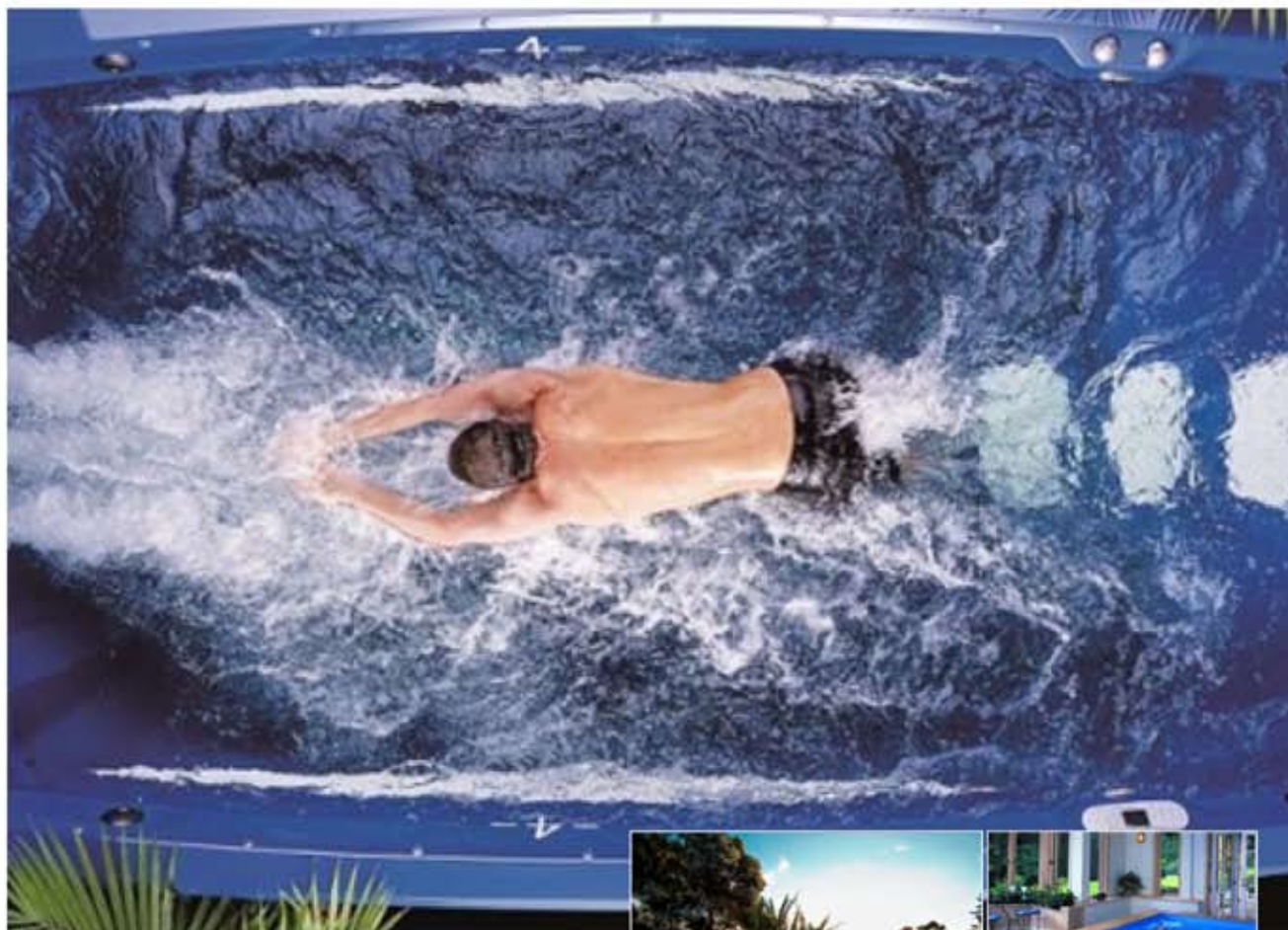

STURDY accurate Efficient
reliable **COMPACT**

- Heat Pumps

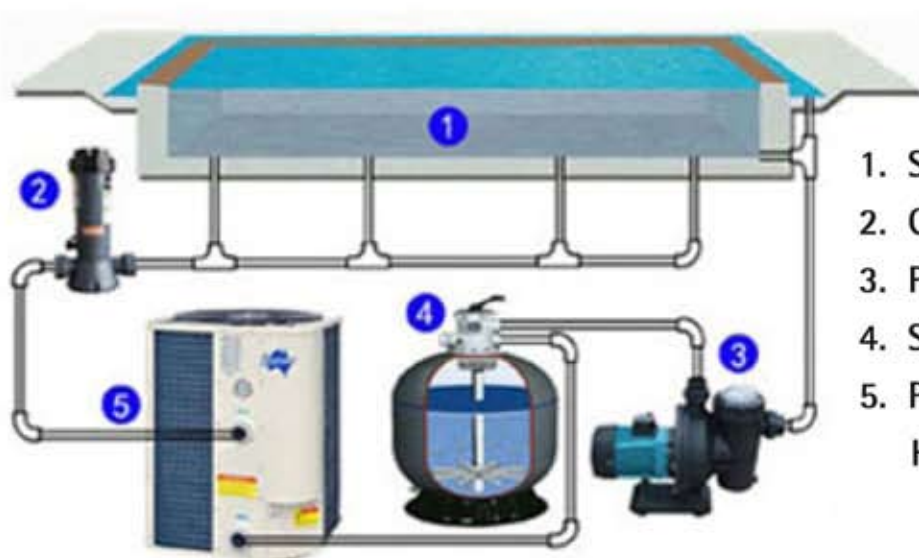
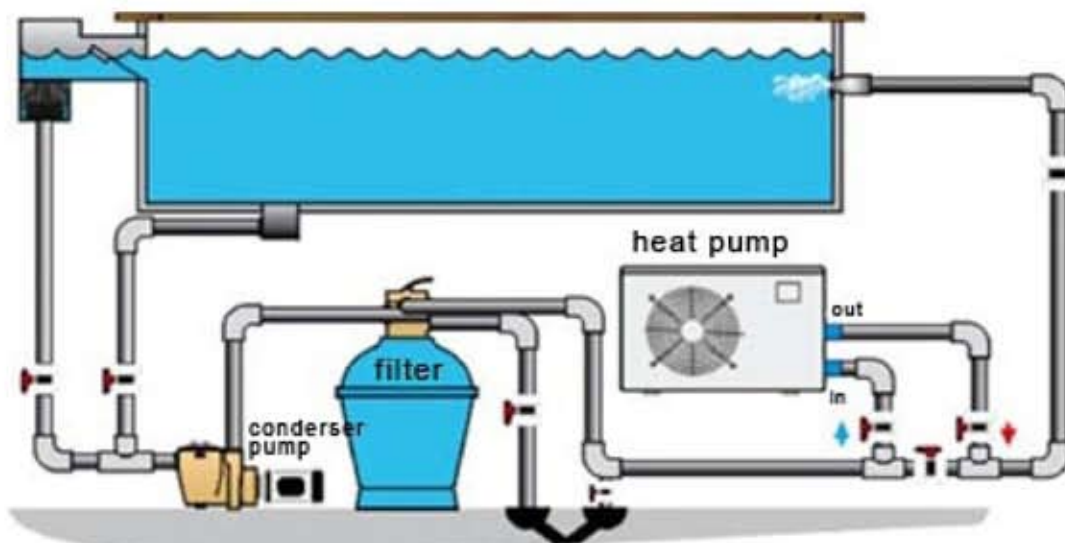

1. Swimming Pool
2. Chlorinator
3. Pump
4. Sand Filter
5. Pool Chiller & Heat Pump



- Heater



STURDY accurate Efficient
reliable **COMPACT**



Life Saving Equipments



- Life Ring



- Floating Bed



- Life Guard Chair



- Life Jacket



- Life Saving Hook



Competition Equipments

- Starting Blocks



- Lane Ropes & Reel



- False Start Indicator Post



- Back Stroke Indicator Post



- Diving Board with Fulcrum



STURDY accurate Efficient
reliable **COMPACT**

Readymade Jacuzzi



Swimming Pool Covers and Roller

We offers a range of swimming pool covers to suit every need, from our exclusive premium quality, premium payback cover, through to the new and unique Geo-Bubble design which has multiple user benefits, right to the long established industry standard 400 and 500 micron traditional Bubble covers with rollers.



STURDY accurate Efficient
reliable **COMPACT**

Pipe less Filter



- Range: 15 m³/hr, 25 m³/hr, 35 m³/hr



Transformer and terminal box



TECHNICAL CHARACTERISTICS

| | |
|-----------------------------|---|
| Dimensions | Variable |
| Flow rate | 15m ³ /h, 25m ³ /h, 35m ³ /h |
| Voltage | 220V / 50Hz or 60 Hz |
| Precision of filtration bag | <5u |
| Operating Noise | <50Db |
| Material | Acrylic |
| Installation | Wall mounting |

EQUIPMENT

| | |
|----------------------------|-----------------------|
| Filtration Pump | 1x1.5HP, 1x2HP, 1x3HP |
| Filtration basket with bag | 1pc |
| Chlorine feeder | 1pc |
| Light | 1 x LED or 100w |
| Time controller | 1pc |
| Swim Jet | 2pcs |
| Handle rail (S.S.) | 2pcs |
| Heater (optional) | 1pc |
| Ozone (optional) | 1pc |

SYSTEM

| | |
|---------------------|-----|
| Filtration System | 1pc |
| Disinfection System | 1pc |
| Time Control System | 1pc |
| Circle System | 1pc |
| Lighting System | 1pc |



STURDY accurate Efficient
reliable **COMPACT**



Pool Side Leisure Furniture



- Lounger Chair



- Umbrella



STURDY accurate Efficient
reliable **COMPACT**

- Rain Dance



- Waterfall



- Fountain



- Mushroom Umbrella



STURDY accurate Efficient
reliable **COMPACT**

UPVC Valves- Fittings- Pipe

(SANKING/ WF/ DUTRON make)



WE are offering good quality UPVC- gray color- valves, fittings and pipe .

=> Thermoplastic Valves

Ball Valve, Check Valve, Foot Valve, Butterfly Valve, Diaphragm Valve

=> Thermoplastic Fittings

Accessory, ASTM Schedule 80 Fittings, DIN PN16 Fittings, Clear PVC Fittings, PPH Fittings, Brass Inserted Fittings

DESCRIPTION :

- 1) Material: UPVC- GRAY
- 2) Size: 1/2"-10"
- 3) Joint End: Socket, Threaded NPT, SPF
- 4) Standard: ASTM, DIN
- 5) Working Pressure: 150-300 PSI
- 6) Operating Temperature: UPVC(0~45)
- 7) Handle color: red, blue
- 8) Valve body color: UPVC (dark gray)



STURDY accurate Efficient
reliable **COMPACT**



APSILON ENGITECH



Factory Address 1

48-GF, Shayona Silver Estate, Rakesh Chemical Lane,
B/h. Silver Oak Collage, S.G. Highway, Gota,
Ahmedabad - 382481 Gujarat, India.



Factory Address 2

86, Neelkanth Industrial Park, Tube Compound,
Near Vatva GIDC Over Bridge, Vatva,
Ahmedabad - 382445 Gujarat, India.



Regd. Office

38, Kailashdham Part-1, B/h Ajay tenament Part-4,
Near Ranchod Colony, Amraiwadi,
Ahmedabad -380026 Gujarat, India.



Phone

Rakesh Prajapati : +91 96012 56690
Ankit Parmar : +91 85111 37186



Email

info@apsilonengitech.com
ap@apsilonengitech.com
rakesh@apsilonengitech.com



Website

www.apsilonengitech.com